



## INSTALLING RAILS AND ROOF RACK:

**Congratulations on the purchase of your Australian made Wedgetail Roof Rack product.  
Please follow these instructions to ensure correct fitment.**

**If no factory rails, please proceed to step 5 Mounting Lug Fitment**

### Factory Rails Removal

1. Remove door rubbers.
2. Remove rear seatbelt sash guide with appropriate Torx spanner, rear demister cable and rear most pillar panel to allow headlining to come down sufficiently to remove Wildtrak rail fastenings.
3. Gently lever down hood lining and remove nuts from the underside of the factory roof rail. These are located above the air bags.
4. Remove the factory Rail to expose mounting holes.



### Mounting Lug Fitment

5. There are 2 types of mounting lug front (larger) & rear (smaller)  
Place front lugs onto roof and tighten using M6 Bolts and Nuts.  
***\*ensure silicone or similar urethane sealant is used under lug to prevent water ingress***

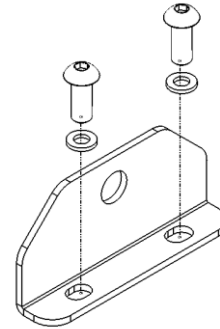

6. Repeat process to mount for rear lugs.
7. Attach Rail to the lugs using 10mm hardware as shown.  
Do not tighten fully.

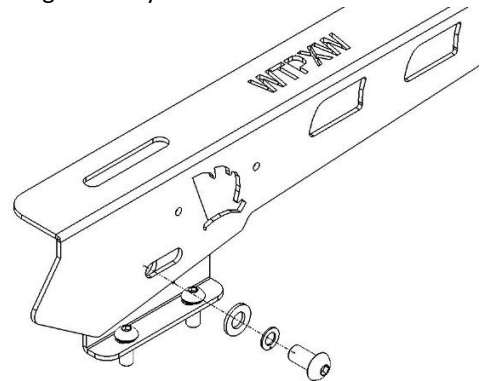

8. Assemble 10mm Bolt / Flat washer / Split washer / Strut Nuts to the top of rail.  
***\*strut nuts to the top as shown in the next diagram***

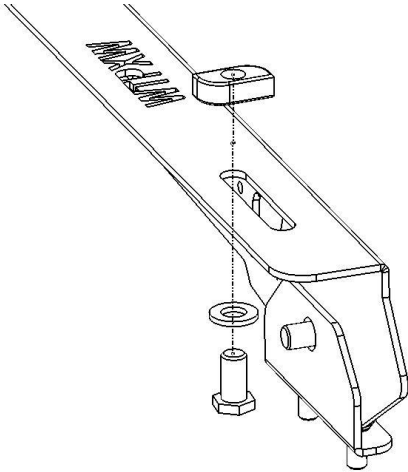

9. Place the Wedgetail Platform on the rail. Do not tighten fully.
10. Centralize the platform evenly on the wedgetail rails.
11. Fully tighten remaining bolts in the following order:
  - a) Rail to the Lug
  - b) Rails to Platform

***\* ensure to push strut nut up and turn 90 degrees in platform crossbar channel to secure***
12. Check fastenings are firmly tensioned at regular intervals  
Do not overtighten to preserve spring washers.

**Thank you for your purchase**

**Please complete your warranty application following correct installation**

**Wedgetail by Tradesman Roof Racks**  
***Innovation through Inspiration***