



Toyota 100 series Wedgetail Fitting

## INSTALLING RAILS AND ROOF RACK:

**Congratulations on the purchase of your Australia made Wedgetail Roof Rack product, please follow these instructions to ensure correct fitment.**

1. Remove rear section of LH and RH black roof channel cover strip from roof.
2. Remove rear and centre mounting bolts from roof.
3. **The front 2 forward mounting points can be found underneath the last curved section of roof channel rubber**
4. Remove the two front mount bolts (Silver Head) from both the sides of the vehicle.
5. Fit mounting lugs to these points  
***\*Ensure to seal threads with silicone or similar urethane sealant to prevent water ingress***
6. Attach lugs to the roof of vehicle using 8mm hardware as shown. Ensure the captive nut is facing inwards towards the centre of vehicle as per the orientation in the below diagram.

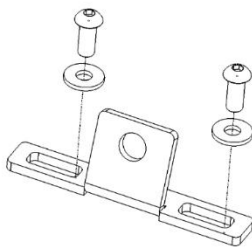

7. Attach Rails to lugs using 10mm hardware with the wedgetail logo facing to the front of the vehicle.

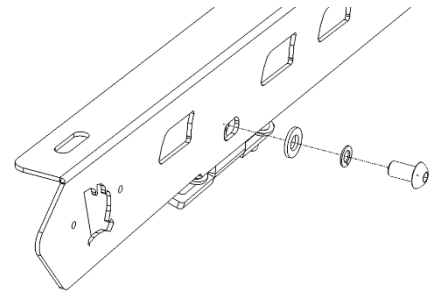

8. Fit 10mm Strutnut to the top of rail as per diagram

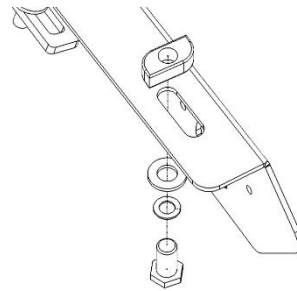

9. Place the Wedgetail Platform on the rail. Do not tighten fully.
10. Centralize the rack side to side on the wedgetail rails.
11. Fully tighten remaining bolts in the following order:
  - a) Rail to the Lug
  - b) Rails to Platform  
***\* ensure to push strut nut up and turn 90 degrees into platform crossbar channel to secure***
  - c) Install Wind deflector using 8mm hardware

**Check fastenings are firmly tensioned at regular intervals**

**Do not overtighten so as to preserve spring washers.**

**Thank you for your purchase**

**Please complete your warranty application following correct installation**

**Wedgetail by Tradesman Roof Racks**

***Innovation through Inspiration***