



Toyota 200s Wedgetail Fitting

INSTALLING RAILS AND ROOF RACK:

Congratulations on the purchase of your Australia made Wedgetail Roof Rack product, please follow these instructions to ensure correct fitment.

**If no factory rails, please proceed to step 5
Factory Rails Removal**

Factory Rails Removal

1. Remove front and rear plastic end caps from factory rails by pushing down from above and pulling outer edge away from base.

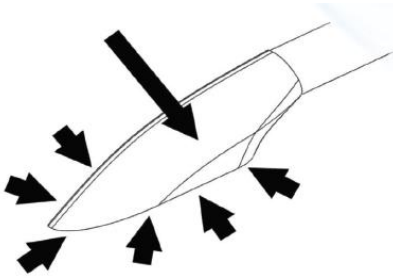

2. Using a flat head screw driver place in the join between the plastic cap and backing plate. Pull cover outwards until clips let go.

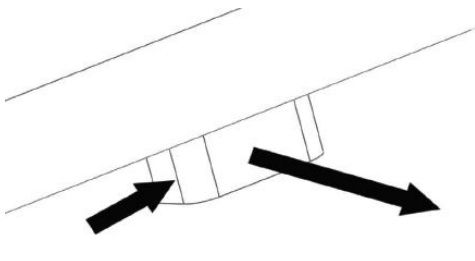

3. Removing the centre mount cover use a small flathead screwdriver place in the side of the mount between the plastic cover and the metal part of the rail. Pull the plastic out towards you until the clips let go.
4. Undo mounting bolts (WARNING, LOOSEN ALL BOLTS FIRST THEN REMOVE, DO NOT LOOSEN AND REMOVE ONE BOLT AT A TIME AS THIS MAY CAUSE THE RETAINING PLATES TO DROP INSIDE THE ROOF LINING). Lift rails off and discard, leaving the rubber channel strips in place. Remove cover strip in roof channel just back from the front mount and remove both bolts (loosen both bolts first then remove). Discard all mounting hardware. Go to step 6.

If no factory rails:

5. Remove 8x plastic cover strips, 4 down each side in the roof channels, pushing them forward (as shown on cover strip by an arrow) and lifting. Then remove all bolts in roof (WARNING, LOOSEN ALL BOLTS FIRST THEN REMOVE, DO NOT LOOSEN AND REMOVE ONE BOLT AT A TIME AS THIS MAY CAUSE THE RETAINING PLATES TO DROP INSIDE THE ROOF LINING), discard all hardware removed.



ROOF RACK INSTALLATION:

6. Apply silicone or urethane sealer (natural cure sealants only) in and around the 16 exposed factory roof holes. Fit 8 rail mounting lugs and cover plates using 8mm hardware (as per diagram below).

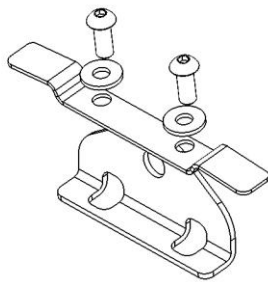

7. Attach rails to the lugs using 10mm hardware (as per diagram below). tighten.

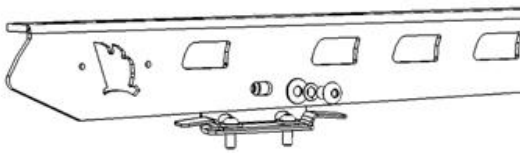

8. Tighten the lug to the roof only, DO NOT tighten the rail to the lug yet!
9. Fit 10mm Bolt / Split washer / Flat washer with the channel Nuts on top of rail.
**Channel nuts to the top as shown in the diagram below*

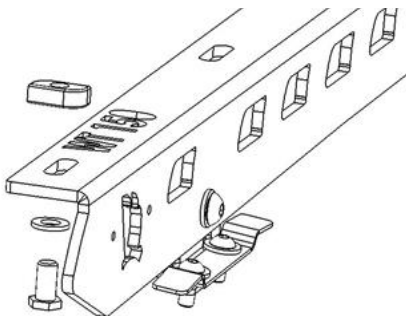

10. Place the Wedgetail Platform on the rails (Wind deflector mounting towards the front of vehicle), then spin the channel nuts 90 degree in the channel on the underside of the rack till they lock into the channels. Do not tighten fully.
11. Fully tighten remaining bolts in the following order:
 - a. Rail to lug
 - b. Platform to rails * Ensure the channel nuts are 90 degree to the channels in the platform.
 - c. Install Wind deflector using 8mm hardware

Thank you for your purchase.

Please complete your warranty application following correct installation

Wedgetail by Tradesman Roof Racks

Innovation through Inspiration